

Low profile, MIL HC-43T/U, cold weld enclosure ideally suited for the manufacture of precision SC cut and AT cut high reliability resonators.

The lower volume enclosure bridges the gap between the standard HC-43/U and the smaller HC-45/U allowing extra space in oscillator designs with only a minor reduction in frequency range and C_1 values.

IT cut resonators may also be provided in this enclosure.

A cold weld sealing process contributes to almost zero contaminants and combined with a high vacuum environment results in exceptional long term ageing and high Q performance.

Custom specified with typical data as follows:

Specification data:

Environment	high vacuum
Quartz orientation	SC, AT and IT cut
Frequency range	(6 ~ 35)MHz fundamental (15 ~ 110)MHz 3rd overtone (55 ~ 170)MHz 5th overtone (110 ~ 200)MHz 7th overtone
Adjustment tolerance	from ± 1.5 ppm at ref. temp. frequency dependent
Thermal stability	OCXO turn point from $\pm 3^\circ\text{C}$ TCXO from $\pm 0.5^\circ$ equivalent \emptyset angle XO from ± 3 ppm temperature dependent
Operating temperature	$(-55 + 105)^\circ\text{C}$ custom specified
Storage temperature	$(-40 + 120)^\circ\text{C}$
Load	custom specified
Shunt capacitance C_0	(1.5 ~ 6.5)pF
Suggested drive level	(5 ~ 150) μW
Q factor	up to 500K, frequency, mode and cut dependent
Ageing - frequency dependent	AT cut: ± 0.5 ppm typical, first year max. SC cut: ± 0.2 ppm typical, first year max.
Insulation resistance	500Meg. Ω min. at 100Vd.c.

Dimensions(mm)

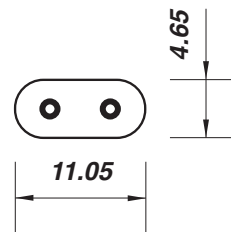
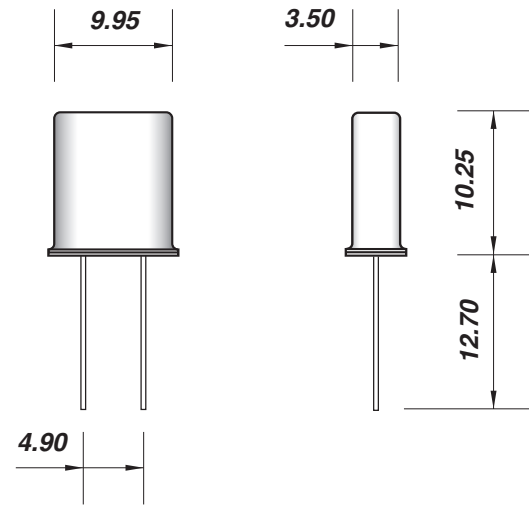

lead diameter 0.43

accessory: crystal grounding clip, hot tin-dipped brass. RoHS compliant

